

# Double Eagle

Product Manual

Fillauer®

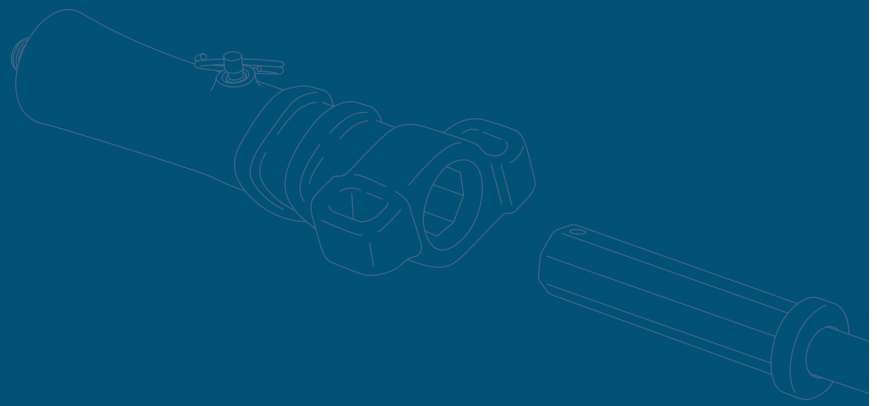

## Intended Use

The Double Eagle is designed to replace the top or leading hand on the club grip. It is the only golf device designed specifically for the bilateral amputee but can also be easily used by the unilateral the desires better rotation control of the clubface. The forgiving flexibility of the main body is designed to improve bio-mechanical action in this swing scenario offering fluid backswing and downswing with excellent face control. The club inserts are installed over the shaft of the club allowing the clubface to be firmly controlled with a single residual limb and no sound hand. The prosthetic hook or sound hand can grasp the body of the device through a special hook interface or directly of the grip on the end. This device comes with one grip insert that is permanently bonded to the club and the user will need to purchase additional inserts for each club they intend to use. It has a standard ½ inch diameter mounting connector to fit most standard wrist openings. Color Black. May be available for direct purchase.

The device is intended for single user/patient use only.

## Included

Double Eagle	
<b>DOUBLE EAGLE</b>	Double Eagle Prosthesis
<b>DE11</b>	Double Eagle Club Grip Adapters
<b>DE03</b>	Double Eagle Trailing Hook Adapter
<b>DE10</b>	5/64 in. Hex Key

## Performance Characteristics

	Double Eagle	DE11 Grip Adapter
Length	6.5 in. (165 mm)	4 in. (102 mm)
Diameter	1.5 in. (38 mm)	1 in. (25 mm)
Weight	7.1 oz. (200 g)	1.1 oz. (30 g)
Thread	½-20	
Age	9+ Years	
Limb Description	Transradial, Transhumeral	

## Indications/Contraindications

This passive-grip golf adapter is intended for specific applications only and is not a true locking device. It holds clubs and other cylindrical handles through mechanical capture and/or elastic materials, and its grip strength may not equal that of a natural hand. The adapter may release under excessive force or certain movements. As with all upper-extremity prosthetic terminal devices, there is a risk of entanglement or impaired release due to the device's design, materials, and lack of sensory feedback. Use of this product involves inherent risk. Proper training and clinical guidance are strongly recommended, especially when using new technology or changing prosthetic controls.

## Storage and Handling

It is recommended that the Double Eagle is stored in a cool, clean, dry environment away from harsh chemicals (chlorine, acids, acetone, etc.).

## Warnings and Precautions



**CAUTION:** Abnormal or improper environmental conditions will lead to malfunctioning and damage of the prosthesis and is not covered under the warranty of the device. This prosthetic component must not be subjected to liquids other than fresh water, abrasives, vibration, or activities which would damage the biological limb. Do not allow debris or liquids to remain in the prosthesis and its components during use. Rinse the TD with fresh water and dry after exposure.



**CAUTION:** While the terminal device is waterproof, the club shaft may take on water if submerged and may cause water damage to the club. Prolonged exposure to water may weaken the club connection to the device. Submerging the device in liquid is not recommended.

## Qualified Provider

Attachment, adjustment, alignment, and delivery of this device must be performed by or under the direct supervision of a qualified prosthetist. Unless stated in this manual, any such activities should not be attempted by the user and will potentially void the device warranty. The club length and alignment with regard to the Double Eagle Club Grip Adapters is to be performed by a professionally-trained golf club fitter.

## Specifications and Preparations Before Use (Risk Management for Installation and Calibration)

### Preparation

Consider the following factors as you determine the most appropriate technology and prosthesis design for your client:

- Does the user understand the function and safety features of the device?
- What other terminal devices will be used with this prosthesis?
- In what types of environments will the device(s) be used?
- In what positions will the person use the device?
- How will the user switch terminal devices? Will quick-disconnect be helpful?
- For what other activities might this device be helpful?
- Will the person benefit from additional training in the use of the device?

### Prosthesis Modifications

The Double Eagle attaches directly to the prosthesis using a standard ½-20 thread.

The Double Eagle should be mounted firmly on the end of your prosthesis so that it has minimal-to-no rotation once positioned correctly. The ring and spring plunger should face anteriorly. The spring plunger facing up will ensure that when you install your golf clubs that they will always index accurately into the Double Eagle and ensure that the club face is correct.

### Club Modifications

Any clubs that you use will need to be modified.

1. Remove the golf grip completely and the club shaft must be cleaned and free of any old adhesive or tape. 2.
2. The club may need to be shortened to fit your height, stature, swing style, etc. Shortening the club shaft 2 – 4 or more inches will compensate for the extra length that the Double Eagle adds to your prosthesis. **We recommend that you consult with a local pro golf club expert to complete these tasks.**

### Hex Adapter Installation

1. Slide the custom hexagonal club adapter down over the end of the club shaft and orient the golf club "FACE" so that it is square at the bottom of the downswing with the large spring plunger hole facing upwards. You can lightly tighten the set screws using the 5/64 in. hex key (provided), and experiment with the position of the club in relationship to the Double Eagle's flexible golf body before "locking" the set screws firmly against the club. Do not over-tighten these set screws, especially with graphite golf shafts to prevent the shafts from cracking.

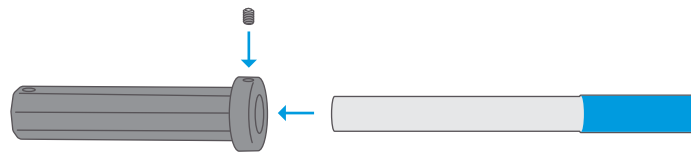

2. Once the club is perfectly positioned, always **use one entire glue pack of adhesive** on each bare club shaft and around inside the Hex club grip to help secure it to the club along with the set screws. On steel/metal shafts a drill index hole can be made to more securely set the screws. Use a drill size like 1/16 inch diameter or smaller to create these holes without compromising the threads in the hexagonal club adapters. Please note that these custom, hexagonal adapters have one large receiver hole on one end and two set screws installed opposite each other, on the "flanged" end. A hex key has been included. The large hole on the proximal end of the custom adapter will receive the plunger that is built into the flexible golf body and controlled by pulling up then releasing the spring plunger ring. **That hole should face upwards towards the sky when installed onto the club shaft.** The set screws at this point will face one up and one down!



**WARNING:** You may wait to finalize the setting until you have experimented with swinging and hitting golf balls but take care because without proper gluing the golf club shaft can pull out of the Double Eagle's Hex adapter during a forceful swing, out of your control and cause damage or injury.



**WARNING:** It is always wise to check the security of the club between play sessions.

### Installation of Club into Double Eagle

1. Slide the hexagonal shaped, custom club adapter up into the hexagonal hole-receiver on the end of the Double Eagle flexible body. The hole that receives the spring plunger will be facing upwards towards the sky.
2. Slide it in until it hesitates-stops.

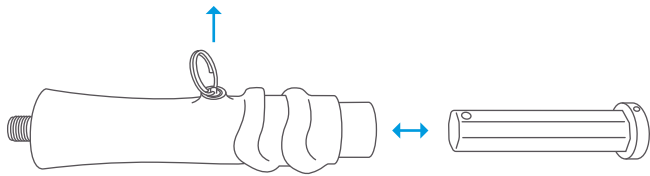

3. Then pull up on the RING lifting the plunger and push the club the extra ~1/2 inch into the Double Eagle...Then RELEASE the ring. The plunger inside will fit down into the hole in the club grip and lock it into the Double Eagle.
4. **Carefully step on the club head and tug on the club to ensure that it is locked into the Double Eagle body.** If not, then reset the plunger by lifting the ring and then releasing it again, until everything is locked in place. Once locked the club grip cannot be released until the ring is pulled up.
5. To remove the club just reverse the operation. Pull up on the ring and pull out the club. Stepping on the club head while performing club extraction will help! Exercise caution when inserting or removing the club to prevent falls and bodily injury.

### First-Time Use

1. Initially swing easily to ensure everything is in place. Then more aggressively as your confidence builds. The rubber “grooves” around the body of the Double Eagle are there to help grip the device directly with your “trailing” hook prosthesis. (See Photos).
2. Experiment with the position of your hook to determine what provides you with the best control, performance and range of swinging motion. Alternatively, you can install the accessory “Trailing Hook Adapter” (THA). See Photos for installation accuracy. The design of the THA allows you to grasp both above and below (Around) the THA using both hook finger holes or some prefer to just grab the upper hole with the hook. (See Photos) The THA was designed more specifically for Split Hooks with “offset” fingers but it will work on other hook designs. Using a hook with offset fingers, install the THA on the Double Eagle so that the lower hole is closer than the upper hole to your hook. But, experiment and practice to determine what works best for your swing and club control and realize that you may not use the THA for every club.

Working with an adaptive golf professional would be a big benefit if possible. Depending upon your swing style and biomechanics the club head face might need to be adjusted so that the club face meets the golf ball properly. This might take some experimentation. That will require repositioning the club shaft inside the custom, hexagonal club grip!

## Compatibility

Fillauer TRS Passive Gripping TDs have been evaluated with and are recommended for use with Fillauer wrists that have a ½-20 internal thread. They may be used with any equivalent ½-20 threaded wrist

units; however, damage caused by other manufacturers wrist units is not covered under warranty of this device.

## Care and Maintenance

These devices require minimal maintenance and care other than keeping them clean and inspecting them before using. Polymer rubbers can deteriorate over time so inspection for cracking or “checking” in the material is recommended. Cleaning regularly is recommended. Treat these devices like your hand from a sanitation perspective. If damage is apparent consult with your prosthetic professional for potential replacement of parts or the entire device, as might be needed. These products are highly reliable when treated and cared for properly.

## Disposal / Waste Handling

The product must be disposed of in accordance with applicable local laws and regulations. If the product has been exposed to bacteria or other infectious agents, it must be disposed of in accordance with applicable laws and regulations for the handling of contaminated material.

All metal components may be removed and recycled at the appropriate recycling facility.

## Warranty

This product has a 12-month warranty against manufacturer defects

## User Instructions

The providing health care professional must review the following information directly with the user.

### Preparation for User

Consider the following factors as you prepare for this device:

- Are you able to don and to doff the device independently?
- Are you able to switch terminal devices independently?
- Are you able to access services from a skilled occupational therapist for additional training if needed?

### Warnings and Precautions for the User



**CAUTION:** Abnormal or improper environmental conditions will lead to malfunctioning and damage of the prosthesis and is not covered under the warranty of the device. This prosthetic component must not be subjected to liquids other than fresh water, abrasives, vibration, or activities which would damage the

biological limb. Do not allow debris or liquids to remain in the prosthesis and its components during use. Rinse the TD with fresh water and dry after exposure.



**CAUTION:** While the terminal device is waterproof, the club shaft may take on water if submerged and may cause water damage to the club. Prolonged exposure to water may weaken the club connection to the device. Submerging the device in liquid is not recommended.



**WARNING:** You may want to finalize the setting until you have experimented with swinging and hitting golf balls but take care because without proper gluing the golf club shaft can pull out of the Double Eagle's Hex adapter during a forceful swing, out of your control and cause damage or injury.



**WARNING:** It is always wise to check the security of the club between play sessions.



**CAUTION:** By adding a golf club to your prosthesis you are extending your effective reach by several feet. It may be difficult to feel motion through your prosthesis. Visually assess your surroundings and exercise caution when swinging this device in order to prevent damage to persons or property.



**CAUTION:** After each play session assess the condition of your residual limb and report anomalies to your prosthetist. Training with an occupational therapist is advised. Improper technique or unintentional ground strikes with the club may convey additional forces to the residual limb.

## Serious Incidents

In the unlikely event a serious incident occurs in relation to the use of the device, users should seek immediate medical help and contact their prosthetist at the earliest possible convenience. Clinicians should contact their local Fillauer representative immediately in the event of any device failure.

*Fillauer*<sup>®</sup>

[www.fillauer.com](http://www.fillauer.com)



**Fillauer**

2710 Amnicola Highway  
Chattanooga, TN 37406  
423.624.0946



**Fillauer Europe**

Kung Hans väg 2  
192 68 Sollentuna, Sweden  
+46 (0)8 505 332 00



© 2026 Fillauer LLC  
M116/04-13-26/Rev.1