

# MC Waterproof Collar for Quick Disconnect Wrist

Prosthetist Manual

# MC Waterproof Collar for Quick Disconnect Wrist (WQD)

## Prosthetist Manual

### Introduction

When used with the MC Forearm Endcap, the MC Waterproof Collar for Quick Disconnect Wrist (WQD) provides a seamless waterproof interface between an ETD or ETD2 and the forearm. This creates a waterproof system to the first opening in the forearm. The wrist functions as a standard quick disconnect for easy changing of terminal devices. This allows the user to switch between a waterproof ETD/ETD2 and a non-waterproof hand for an evening on the town. The WQD is compatible with not only the MC passive wrist rotation Forearm Endcap but also Motion Control electric wrist rotators.

The WQD consists of two components which provide the waterproof seal. The waterproof Forearm Endcap and the waterproof terminal device (TD) collar. The endcap **must** be the new MC style for waterproof sealing (manufactured since 09/18/2019). These components together facilitate submersion of the prosthesis up to the first opening in the socket (data port, power switch, trimlines, etc.).

The WQD is installed on the terminal device (TD) quick disconnect by Motion Control to ensure waterproof sealing of the device.

### Special Precautions



#### The WQD requires periodic maintenance

Failure to maintain the device, may likely cause wear, water leakage and damage. Damage caused by lack of maintenance is not covered by warranty.



#### Compatibility

A TD with the Waterproof Collar for Quick Disconnet Wrist is not compatible with MC Endcaps manufactured before 09/18/2019. They are also not compatible with Otto Bock forearm wrist components.



#### The Waterproof Collar is not serviceable

Do not remove the waterproof collar from the Terminal Device. If it is damaged, it must be returned to Motion Control for repair and testing.



#### Contamination

Dust, dirt, grit and contaminates will damage the O-ring seal. When installing a TD with the waterproof collar, a tissue, handkerchief or Q-tip should be used to clean the mating surface of the endcap.



#### Organic Solvents

Organic solvents will damage the O-ring and plastic components of quick disconnect and endcap. Do not submerge either the TD or wrist in solvents or caustic chemicals.



#### Waterproof Collar Protection

The waterproof collar protects the quick disconnect wrist. The components inside the forearm, e.g. batteries, electrodes, electric wrist rotator etc are not protected from ingress of water from the socket or forearm. This includes perspiration from the socket and/or pull tube.



#### Serious Incidents

In the unlikely event a serious incident occurs in relation to the use of the device, users should seek immediate medical help and contact their prosthetist at the earliest possible convenience. Clinicians should contact Motion Control immediately in the event of any device failure.

## Installation of the MC Forearm Endcap\*

The newly designed MC Forearm Endcap is almost identical to the previous endcap. The endcap must be used in conjunction with the lamination collar. The lamination collar must be laminated in, not glued. Also, use the lamination dummy kit (part number 3010886) when fabricating the forearm.

The O-ring that provides the seal between the lamination collar and the endcap requires a very snug fit to ensure a waterproof seal. Installing a terminal device onto the endcap aids installation of the endcap and eases alignment of the screw holes. When installing the screws, pay special attention to the screw O-rings. Kinked, torn, missing or otherwise damaged O-rings will cause the unit to leak.

Start all 5 screws, then progressively tighten each one for correct alignment.

\*Purchased separately

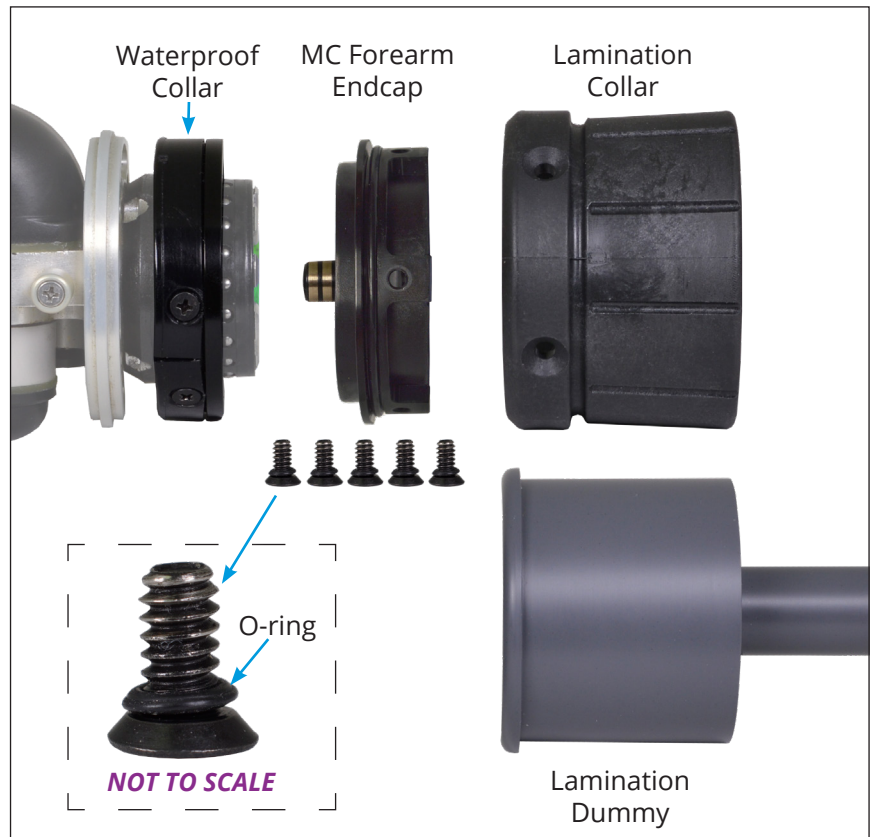

## Installation of Waterproof Collar

The waterproof collar is installed at Motion Control, and tested to ensure it is waterproof. It is not field-serviceable.

## Maintenance Schedule for WQD

The MC Waterproof Collar for Quick Disconnect Wrist works by creating a seal between the endcap of the forearm and the WQD collar on the terminal device (TD). These two surfaces rotate on each other. As such, it is important to lubricate and preserve the sealing surfaces of the collar and endcap.

Dirt, grit, lint and other contaminants should be cleaned from the endcap before installing a terminal device with a waterproof collar. This is accomplished by simply wiping the surface with a tissue, soft cloth or Q-tip. Visually inspect the endcap sealing surface to ensure there are no dings or scratches that might prevent the proper functioning of the seal. If the sealing surface is damaged, please contact Motion Control.

Every 3 months, apply Super Lube (supplied) to the O-ring inside the waterproof collar. To grease the O-ring, place some Super Lube on a cotton tip applicator. Then move the greased end of the applicator around the inside diameter of the aluminum ring. If noise develops, squeaking, grinding or rubbing sounds, at any time when rotating the wrist, remove the TD from the forearm, clean the collar and the endcap with a Q-tip and rubbing alcohol and reapply Super Lube. If the noise does not subside, consider the wrist no longer waterproof and return it to Motion Control for servicing as soon as possible.

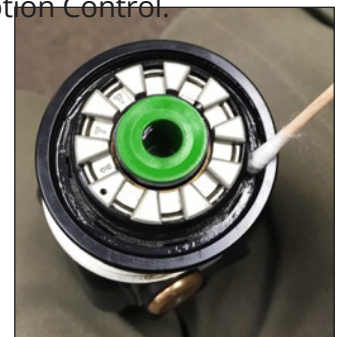

## Limited Warranty

Seller warrants to Buyer that the equipment delivered hereunder will be free from defects in materials and manufacturing workmanship, that it will be of the kind and quality described and that it will perform as specified in Seller's written quotation. The limited warranties shall apply only to failures to meet said warranties that appear within the effective period of this Agreement. The effective period shall be one year (12 months) from the date of delivery to the fitting center that has purchased the components. Refer to the shipping receipt for the date of shipment.

## Return Policy

Returns are accepted for a full refund up to 90 days from date of shipment as long as the item is in resalable condition. Beyond 90 days, returns are not accepted.

## Declaration of Conformity

The product herewith complies with the Medical Device Directive 93/42/EEC guidelines, and with the United States Food and Drug Administration.



## QD Wrist Parts

Description	Tan	Brown	Black	Part No.
* Lamination Collar for MC Wrist, 7 1/4 Hand	1100292	1100296	1100288	-
Lamination Collar for MC Wrist for Hosmer Prefab (LRG), Boston or AFB	-	-	1100291	-
Forearm Endcap	-	-	3010758	-
Wrist Lamination Dummy Kit	-	-	-	3010886
Otto Bock style Coaxial Plug	-	-	-	1701009

\* Hand sizes are for reference only; MC Hand is not waterproof

## Customer Support

### Americas, Oceania, Japan

#### Fillauer Motion Control

115 N. Wright Brothers Drive  
Salt Lake City, UT 84116  
801-326-3434  
motioninfo@fillauer.com

### Europe, Africa, Asia

#### Fillauer Europe

Kung Hans väg 2  
192 68 Sollentuna, Sweden  
+46 (0)8 505 332 00  
support@fillauer.com



www.fillauer.com



#### Fillauer

2710 Amnicola Highway  
Chattanooga, TN 37406  
423.624.0946



#### Fillauer Europe

Kung Hans väg 2  
192 68 Sollentuna, Sweden  
+46 (0)8 505 332 00

