

# Mounting a Motion Control Touch Pad

## Fact Sheet

### Instructions

1. Carefully determine the best location for mounting the touch pad(s). Ideally, each touch pad should be mounted on a flat surface where it can operate without the wire bending (Fig. 1). If the touch pad is mounted in a bent or flexed position, this may affect the proper operation of the device or cause it to malfunction.
2. Cut out the drill template (Fig. 2) and place on the prosthesis. Mark the two screw hole locations. Drill and countersink two mounting holes using a #43 (0.089") drill bit.
3. Install the two included 2-56 x 3/8" flat head screws through the socket and into the touch pad assembly. Tighten the screws firmly (Fig. 3). Note: Other lengths of 2-56 screws are commonly available if needed.
4. Mark the screw length protruding beyond the inside face (lift lid up as shown below), remove the screws and cut off the protruding length. Deburr any sharp edges, re-install the screws and tighten them firmly to hold the touch pad assembly in place.

Figure 3

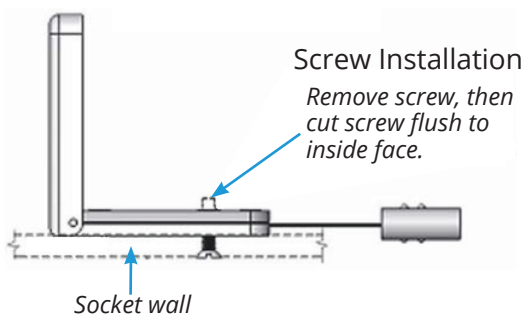

Note: Use care when placing the flex connector; do not bend wire sideways.

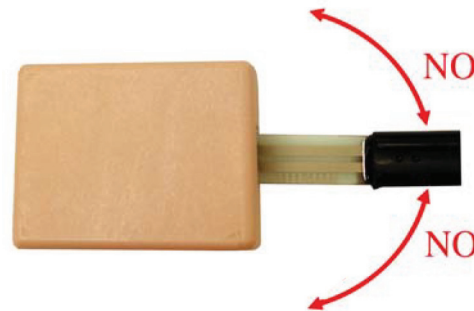
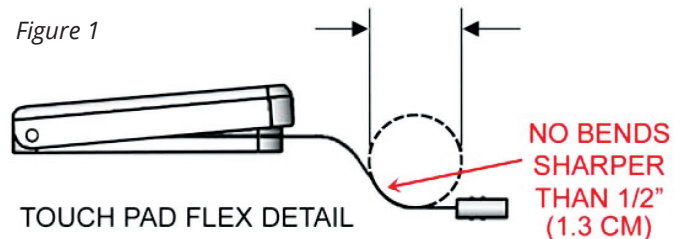
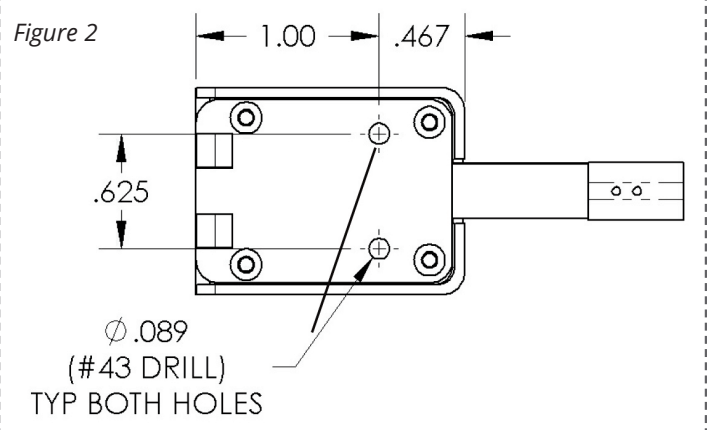

Figure 1



Mount touch pad on a flat surface without bending the flex connector.

Figure 2



## Customer Support

### Fillauer Motion Control

115 N. Wright Brothers Drive  
Salt Lake City, UT 84116  
801-326-3434  
motioninfo@fillauer.com

**Fillauer**



2710 Amnicola Highway  
Chattanooga, TN 37406  
423.624.0946  
www.fillauer.com

EC REP

### Fillauer Europe

Kung Hans väg 2  
192 68 Sollentuna, Sweden  
+46 (0)8 505 332 00  
support@fillauer.com



© Fillauer Motion Control, 1910032 Rev C 06-05-25