

INSTRUCTION SHEET SOFT VOLUNTARY OPENING (SVO) HAND WITH DORSAL CABLE

Introduction:

This light weight hand provides a functional, cosmetically pleasing terminal device for wear and use in light-duty activities. A prehension force of 4 to 6lbs (18 to 27N) at 1in (2.5cm) opening is provided. The Inner Shell is made of a sturdy PVC material, with elastomer pads reinforcing the finger tips. These pads should provide extended wear and strong gripping surfaces.

Heavy duty users may find a heavier hand required for serviceability and the Dorrance Hook is still recommended as the preferred terminal device for “work use”.

Instructions:

Adjusting Prehension

1. The adjusting prehension has been set at 4.5lbs (20N) at the factory. This prehension may be adjusted by using a hex wrench in the spring shaft. This is accomplished by first loosening (but not removing) the hex nut (Item 15). Next, install the hex wrench into the shaft (Item 2) and tighten the spring - using a prehension gage at the finger tips. Add about .5lb (2.2N) to compensate for resistance of the shell. Then tighten the hex nut. Coat coils of spring (Item 8) with white lithium grease.

Glove Donning & Doffing Instructions

The flexibility of the shell requires that precaution be taken when donning and doffing the glove.

Instructions To Donn the Glove:

1. Apply the Glove Donner (Hosmer PN 51218) to the hand. This will keep the hand in an open position.
2. Cover the hand shell with Silicone Grease (Hosmer P/N 51841).
3. Heat the glove approximately 6 minutes in a Convection oven at no more than 200 degrees Fahrenheit (93 degrees Celsius). The glove will be very flaccid almost to the point of losing its shape.
4. Spray the inside of the glove with silicone and apply silicone grease around the opening of the glove.
5. Gently pull the glove over the fingers first, then down over the rest of the frame.

Instructions to Doff the Glove:

1. Spray the glove with silicone.
2. Reflect (fold back) the end of the glove sleeve.
3. Pull up on the glove while holding the base of the hand so that the cover does not slip off the wrist bracket or migrate with the glove.
4. Continue to reflect the glove using caution near the fingers and top of the knuckle area.

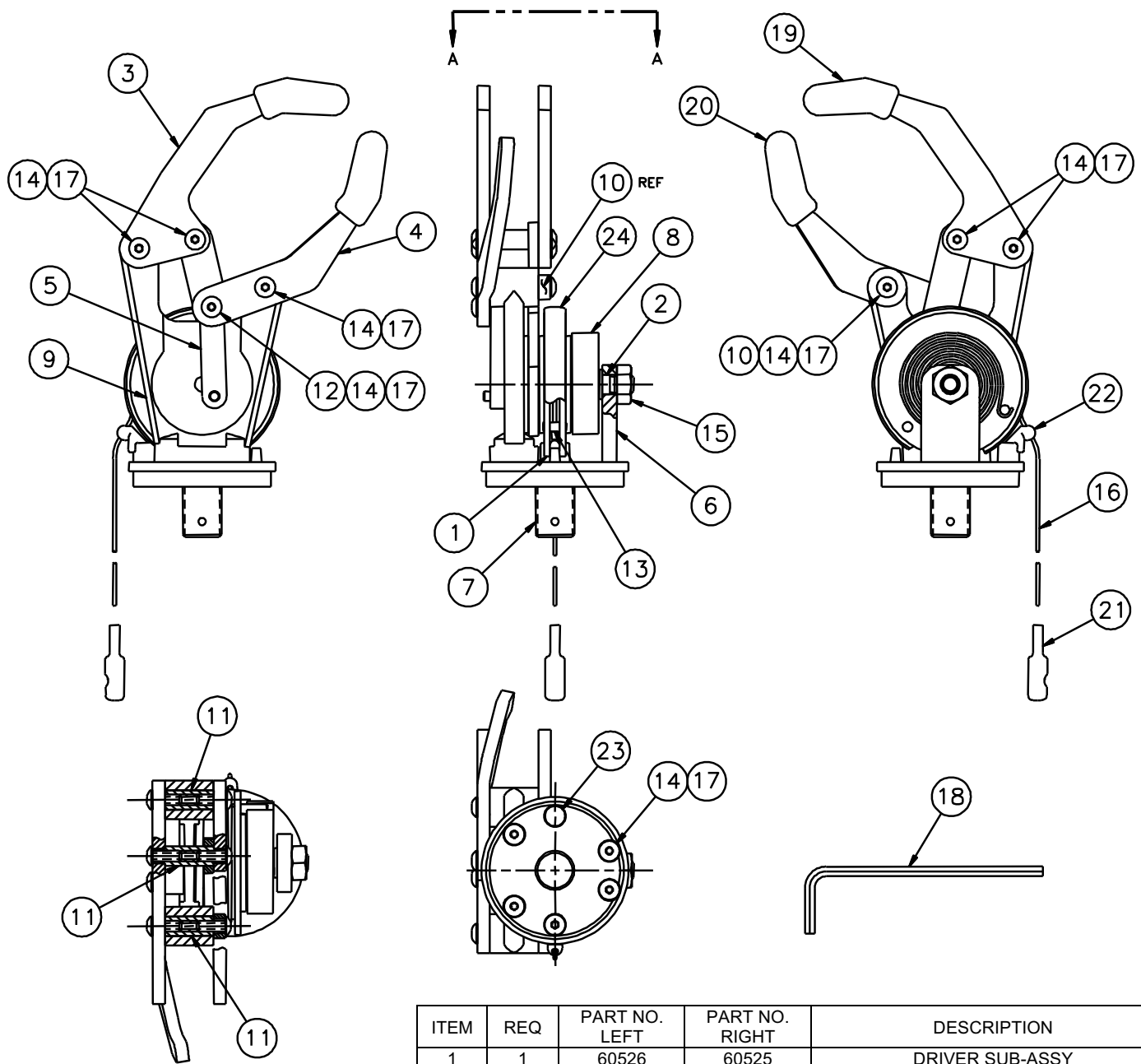

VIEW A-A

SHELL PART NUMBERS	
61525	7.25 RIGHT
61526	7.25 LEFT
61527	7.75 RIGHT
61528	7.75 LEFT
61529	8.00 RIGHT
61530	8.00 LEFT

ITEM	REQ	PART NO. LEFT	PART NO. RIGHT	DESCRIPTION
1	1	60526	60525	DRIVER SUB-ASSY
2	1	60501	60501	AXLE, TORQUE ADJUSTER
3	2	60521	60521	FINGER
4	1	60520	61091	THUMB, MACHINED
5	1	60504	60504	THUMB, CONNECTING ROD
6	1	60506	60506	BACK SUPPORT PLATE
7	1	61060 61264 60508	61060 61264 60508	BASE, SMALL (7.25) BASE, MEDIUM (7.75) BASE, LARGE (8.00)
8	1	60509	60509	SPRING, HAND
9	1	60920	60920	MAIN SUPPORT SUB-ASSY
10	1	60511	60511	SPACER
11	3	60512	60512	AXLE SHAFT
12	1	60513	60513	BEARING, CONNECTOR LINK
13	1	60514	60514	PIN, DOWEL CABLE
14	12	60518	60518	SCREW, BUTTON HD 6-32 X .375 LG
15	1	60519	60519	NUT, HEX JAM
16	1	50724	50724	CABLE ASSY
17	A/R	70243	70243	LOCTITE 242
18	1	72058	72058	WRENCH HEX 1/8
19	2	61092	61092	TIP, FINGER
20	1	61093 61271	61093 61271	TIP, THUMB (7.25, 7.75) TIP, THUMB (8.00)
21	1	50419	50419	BALL RECEIVER
22	1	61268	61268	GUIDE, CABLE
23	1	61291	61291	PLUG, VINYL
24	1	61412	61412	COVER, CABLE