



TRAUTMAN MOTOR LIFT ASSIST

from Fillauer LLC

**INSTALLATION
GUIDE**

Fillauer
COMPANIES

TABLE OF CONTENTS

- Motor Lift Assist Kit4
 - Parts
 - Tools Needed
- Installation 5-8
 - Use of Lift Assist After Installation
- Shock Replacement 9-11
 - Removal of Old Shock
 - Installation of New Shock

MOTOR LIFT ASSIST KIT

PARTS



Lift Assist Shock
PN 390218



Bottom Shock Mount
Column Clamp
PN 390215



Middle Shock Support
Column Clamp
PN 390216



Top Motor
Riser Ring
PN 390217



Motor Housing
Column Ring Bearing
PN 390219



Motor Housing
Column Thrust Washer
PN 390221

TOOLS NEEDED

$\frac{5}{16}$ in. hex key

MOTOR LIFT ASSIST



INSTALLATION

1. It is a two person job to remove the motor and motor housing column clamp assembly. Unplug and remove the motor housing clamp assembly and set it in a secure place.

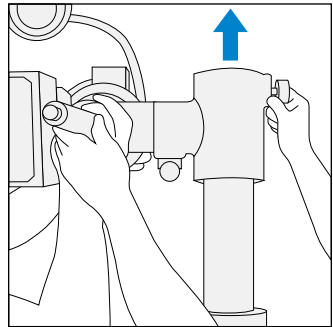

2. Remove the safety stop bolt located on the bottom third of the column using a $\frac{5}{16}$ in. hex key and set it aside.

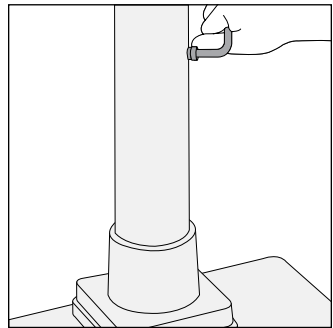

3. **Bottom Shock Mount Column Clamp**
The standard location for the bottom shock mount column clamp should be set to 15 in. from the top surface of the Trautman base to the bottom of the clamp. *This measurement varies depending on user.*

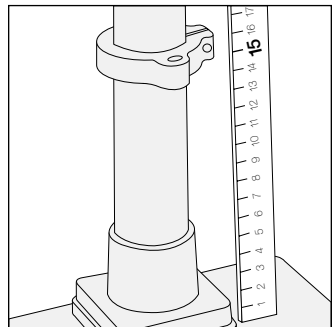

The shock mounting hole located on the base clamp should be orientated so it corresponds with the front of the motor housing assembly (Fig. A). Tighten the shock mount column clamp bolt to 25 ft. lbs. before moving to the next step (Fig B).

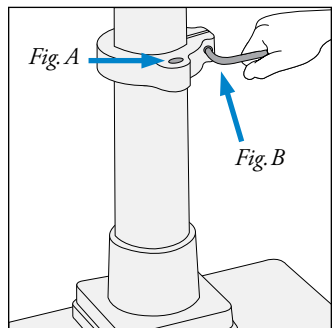

Reinstall the safety stop bolt.

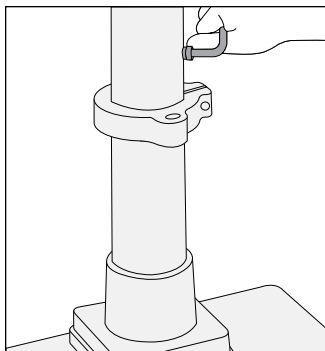

4. Lift Assist Shock

Line up the bottom of the shock with the threaded hole on the bottom shock mount column clamp.

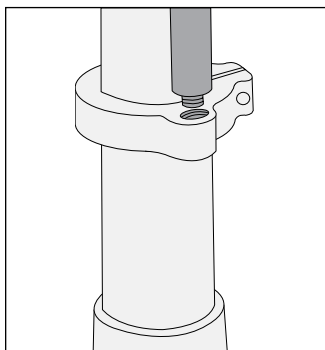

Turn the shock clockwise until it has been seated.

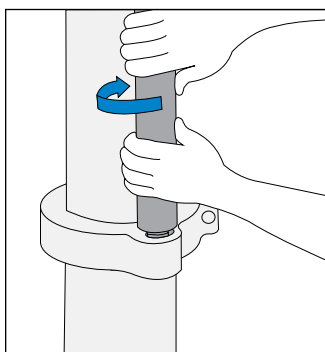

5. Middle Shock Support Column Clamp

This clamp should be set so that the top of the support clamp is even with the end of the shock (Fig. A). Tighten the clamp bolt to 25 ft. lbs. (Fig. B).

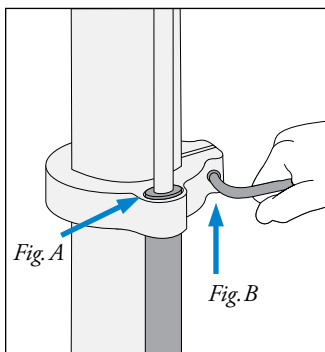

6. Top Motor Riser Ring

Slide the top motor riser ring the over column and line up the threaded hole with the shock shaft.

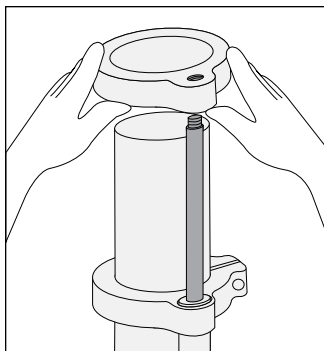

Turn only the top part of the shock clockwise until it is threaded into the motor riser ring. Check to make sure that during this step the bottom of the shock has not come unthreaded. If so, rethread it until both are seated.

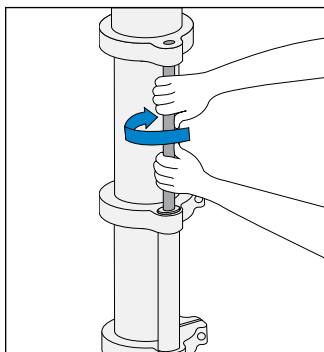

7. Motor Housing Column Thrust Washer

Slide the thrust washer over the column until it comes into contact with the top surface of the motor riser ring.

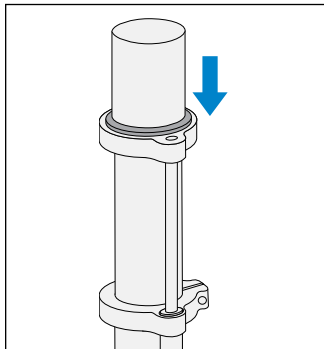

8. Motor Housing Column Ring Bearing

Slide the bearing over the column until it comes in contact with the top surface of the thrust washer.

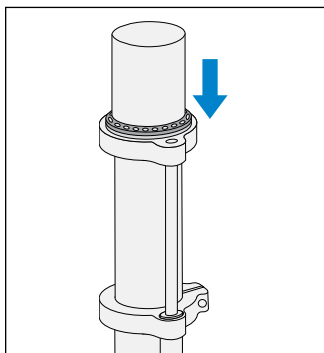

9. With assistance from another person, reinstall the motor and motor housing column clamp assembly. Make sure that the orientation of the motor and motor housing column clamp is setting over the shock and tighten the column clamp handle.

Installation is now complete.

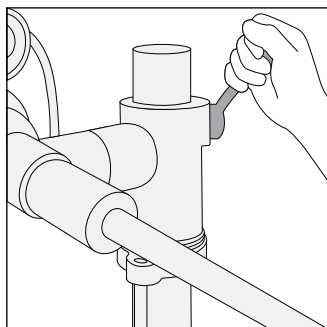
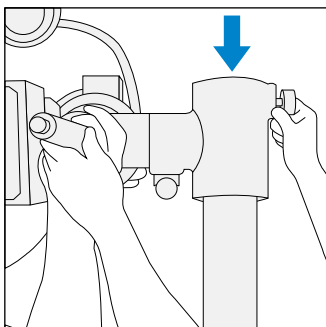

USE OF THE LIFT ASSIST AFTER INSTALLATION

1. To lower the motor, simply loosen the column clamp handle and using both hands push down on the column clamp until desired height is achieved. Retighten the column clamp handle to secure the desired height.

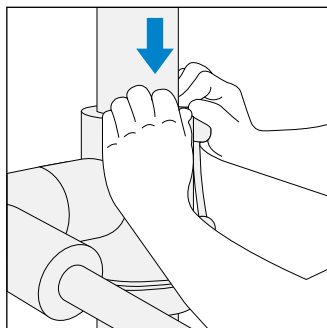
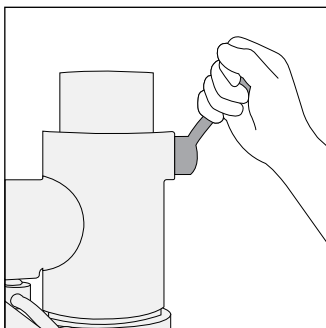

2. To raise the motor, simply loosen the column clamp handle and with both hands located under the top column motor riser ring push up on the assembly until desired height is achieved. Tighten the column clamp handle to resecure the motor into its location.

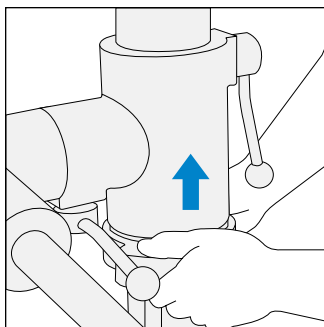

SHOCK REPLACEMENT

REMOVAL OF OLD SHOCK

1. With assistance, raise the motor housing column clamp assembly up 6 in. above the top motor riser ring. The shock should be at full extension. Lock the motor housing column clamp into place; make sure that the motor and motor housing column clamp assembly handle is secure by trying to tighten the handle.

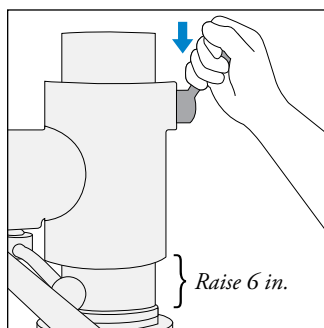

2. Loosen and raise the middle shock support column clamp.

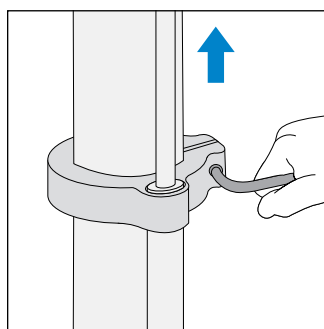

Retighten it under the top motor riser ring.

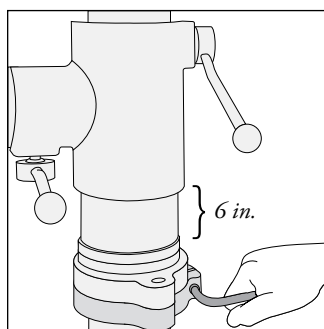

3. Loosen the bottom shock mount column clamp bolt.

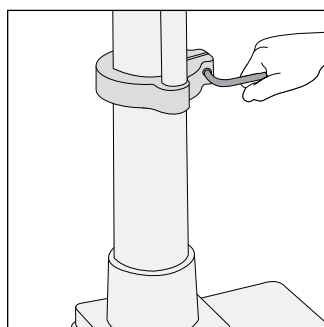

Next, turn the bottom of the shock counterclockwise until it is free of the clamp, and then lower the clamp to the bottom of the column.

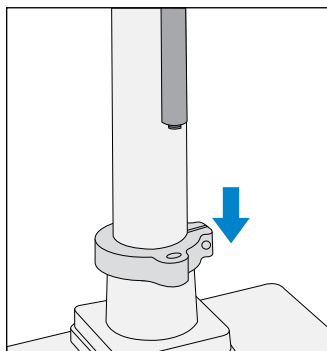
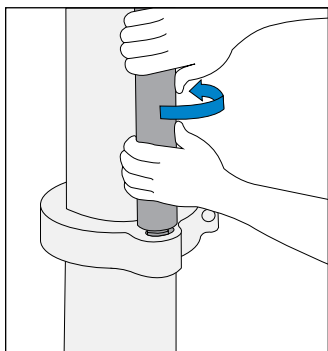

4. Loosen the top of the shock from the top motor riser ring by turning it counterclockwise until it is free and remove the shock.

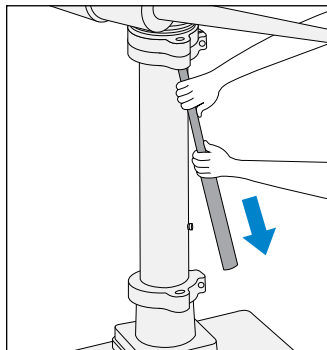
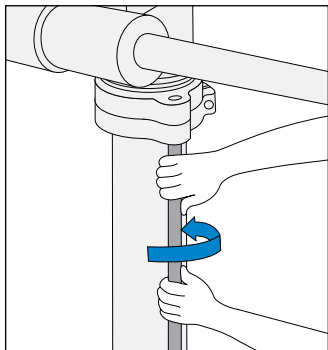

INSTALLATION OF NEW SHOCK

1. Install the new shock first by securing it to the top motor riser ring by threading it into the ring. Turn the top part of the shock into the riser ring clockwise until the thread is completely seated.

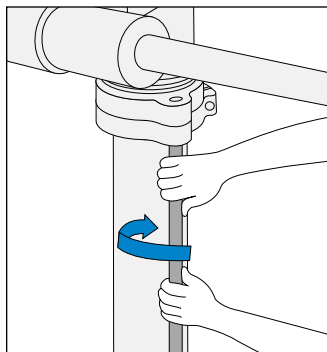
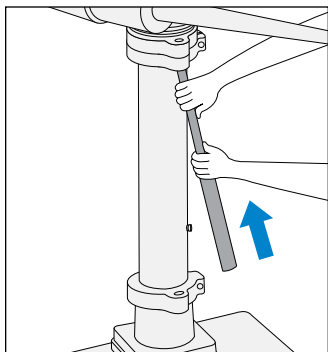

2. Lower the middle shock support clamp to the top of the shock and secure it by tightening the clamp to 25 ft. lbs.

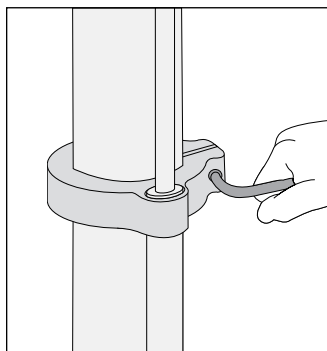
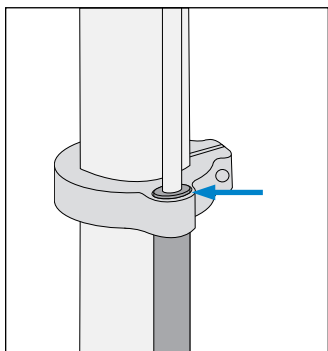

3. Raise the bottom shock mount column clamp to the bottom of the shock and thread it onto the shock by turning the bottom of the shock clockwise until it is completely threaded into the clamp. Make sure that the top part of the shock did not come loose, if so simply retighten it.

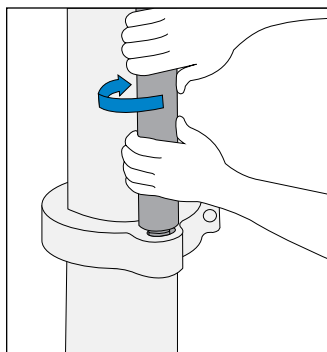
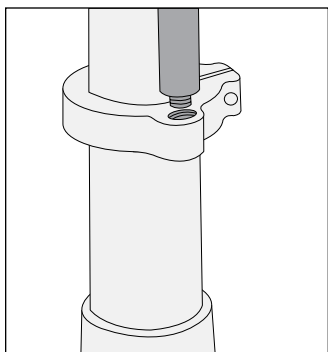

Tighten the bottom shock mount column clamp bolt to 25 ft. lbs.

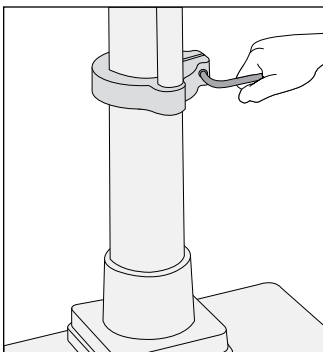

Now your lift assist is ready to use.



Fillauer LLC

2710 Amnicola Hwy
Chattanooga, TN 37406
800.251.6398
423.624.0946
www.fillauer.com

Hosmer

561 Division Street
Campbell, CA 95008
800.827.0070
408.379.5151
www.hosmer.com

Centri

Kung Hans Väg 2
192 68 Sollentuna, Sweden
+46 8 505 332 00
Fax +46 8 505 332 05
www.centri.se